

EVERYDAY MAINTENANCE AND REMOVAL OF COMMON STAINS

As with any other material for interior design, a FENIX® surface should be cleaned regularly. It does not require any special maintenance, just a damp cloth with warm water or a cleaner e.g. Ajax® Spray n' Wipe.

For the most common stains, you can simply clean the surface with warm water using a non-abrasive cloth. Tougher stains can be removed with non-abrasive household cleaners or solvents.

For older, dried or caked-on stains, use a magic/melamine sponge or damp soft cloth to remove them. After using any solvents, we recommend rinsing the surface with warm water and a detergent. Always rinse thoroughly to remove the detergent with clean warm water.

STUBBORN STAINS AND MINOR SCRATCHES

FENIX® surfaces have a unique non-porous external layer, allowing you to keep it neat with simple, everyday care and cleaning methods. In case of stubborn stains, we recommend the use of a specific cleaning agent (as per the table included on reverse) to remove any trace of the stain.

In case of superficial micro-scratches, please refer to the Maintenance Instructions for the surfaces as illustrated below. For more stubborn scratches please contact your fabricator/joiner/kitchen company for advice.

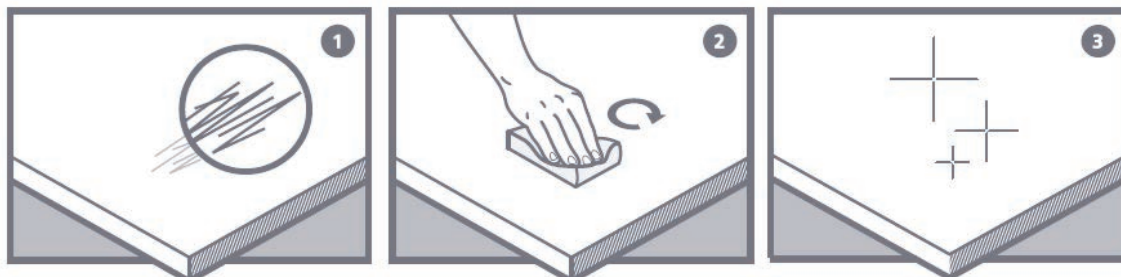
MAINTENANCE INSTRUCTIONS

1. Superficial defects caused by micro-scratches.

2. Rub the magic sponge on the area where the micro-scratches can be seen. The sponge can be used dry or slightly damp.

3. The surface should now be healed.

Melamine or magic sponges, also known as cleaning erasers are available from stores such as Mitre10, Bunnings and Kmart.

USEFUL CLEANING ADVICE

For the best results when cleaning FENIX®, it is important to remember the following advice:

- Although very resistant, a FENIX® surface must still never be treated with products containing abrasive substances, macro abrasive sponges or unsuitable materials such as sandpaper or steel wool;
- Strongly acidic or alkaline products should be avoided because they can stain the surface;
- Bleach and heavily-chlorinated products should be avoided because they can degrade the surface;
- When using solvents, the cloth used must be perfectly clean so as not to leave marks on the FENIX® surface. Any dry marks may, however, be removed by rinsing with hot water and drying well;
- Do not use furniture polish or wax based cleaners in general, because they tend to form a sticky layer on the FENIX® surface that attracts and traps dirt;
- Do not use metal scrapers, iron brushes or any other metal tool to remove stains, paint, plaster or other substances from the surface.

CLEANING INSTRUCTIONS

CATEGORY	TYPE OF STAIN	AGE		
		LIGHT	MODERATE/RECENT	STUBBORN
EVERYDAY DIRT	Dust, general dirt, grease	1	2	2
	Fingerprints, nicotine stains	3	4*	4*
	Traces of limescale, rust	2	5	5
Food & Drinks	Syrup, fruit juice, sugar syrup, jam, caramel, spirits, milk, tea, coffee, wine, beer	1 or 2	2	2
	Animal and vegetable fats and oils, sauces, eggs	3	4*	4*
Cleaners & Polishes	Detergents, soap	1 or 2	2	2
	Furniture, floor and shoe polish	3	3	4**
Paints & Inks	Pencil marks, chalk	1	2	2
	Pen ink, markers	4**	4**	4**
	Watercolour paint, colours and adhesive soluble in water	2	2	2
Cosmetics	Lipstick	3	3	4**
	Hairspray, foundation, face powder	4**	4**	4**
	Nail polish	7+4**	4**	4**
Organic Fluids	Germs, bacteria, blood, bodily fluids	6	6	6

CLEANING INSTRUCTIONS – KEY

1. Use a soft cloth or paper towel, either dry or dampened with water.
2. Use warm water (up to 35-40°C) with soap or a mild household detergent, leaving it to work until the dirt starts to loosen.
3. Initially use a dry soft cloth or paper towel. Then use warm water (up to 35-40°C) with soap or a mild household detergent, leaving it to work until the dirt starts to loosen.
- 4*. Use a dedicated solvent (e.g. turpentine or white spirit), then use warm water (up to 35-40°C) with soap or a mild household detergent leaving it to work until the dirt starts to loosen
- 4**. Use a dedicated solvent (e.g. acetone or nail polish remover), then use warm water (up to 35-40°C) with soap or a mild household detergent, leaving it to work until the dirt starts to loosen.
5. Use detergents containing acetic acid or citric acid not more than 10% concentration. Rinse with plenty of warm water.
6. After using warm water (up to 35-40°C) with soap or a mild household detergent leaving it to work until the dirt starts to loosen, wash with disinfectant from supermarkets. Steam can also be used with this type of dirt.
7. Immediately use a dry soft cloth or paper towel, to remove initial spillage.